





DATA 2

SELF-CONTAINED ADDRESSABLE SYSTEM

DATA 2 EASY

SELF-CONTAINED ADDRESSABLE SYSTEM



- » Monitoring of the configured system with up to 512 fittings - ideal for small and medium-sized investments.
- » All parameters of the fittings, the addresses of which are displayed in the control panel, are downloaded by the panel in a continuous manner.
- » Possibility to download reports and logs stored in the device's memory.
- » Software update via USB port.
- » Communication between the panel and fittings is carried out by means of the built-in C-BRIDGE 2 signal splitter, through the two-wire TM-Bus communication bus, which does not require polarisation maintenance.
- » Easy and intuitive navigation via keyboard and LCD display, additional possibility to connect the keyboard or mouse via USB port.

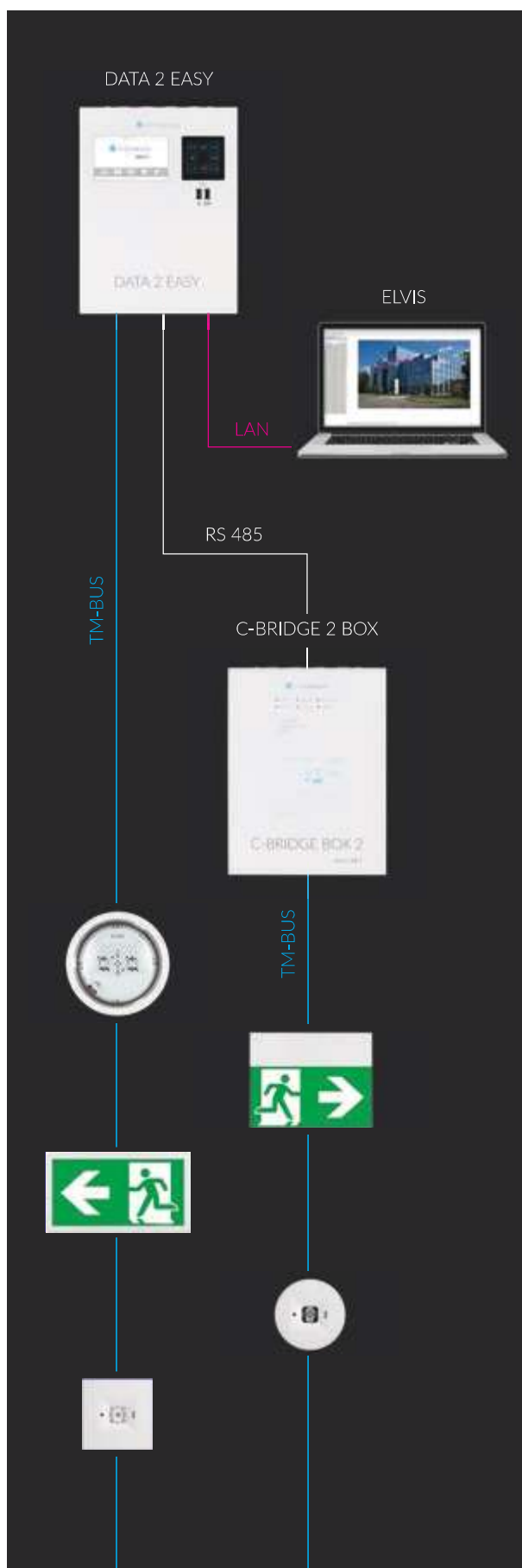

$$64 \times 4 \times 2 = 512$$

maximum number of emergency
fittings / channel

maximum number
of communication channels

maximum number
of signal distributor

maximum number of emergency
fittings in the system

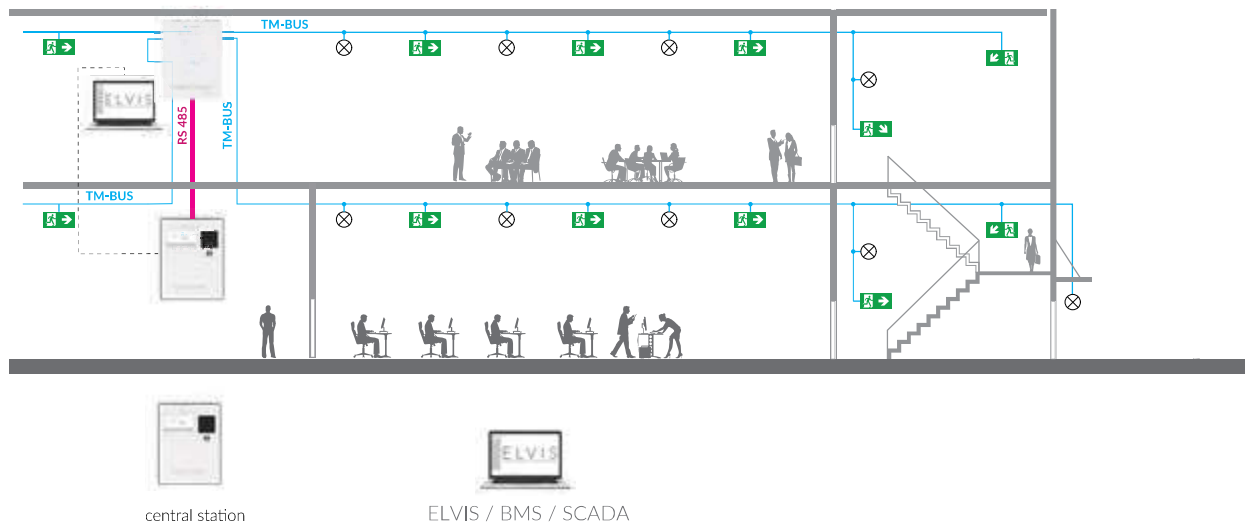

BASIC SYSTEM PARAMETERS

Max. number of emergency fittings / channel	64
Maximum number of communication channels	4
Maximum number of C-Bridge 2 signal distributor	2
Max. number of emergency fittings in the system	512



HOUSING DATA 2 EASY

Dimensions (H x W x D)	307 x 230 x 59 mm
Material	RAL 9003 powder coated black steel
Protection degree	IP20
Insulation class	I

WIRING

Communication with controller	RS 485 port
Communication with ELVIS, WWW, MODBUS TCP	LAN
Communication with addressable devices	<p>TM-BUS 2-wire data bus (without polarity) - communication cable</p> <p>for example: YTKSYekw 1 x 2 x 0.8 mm² or other wires complying with the parameters:</p> <p>length: max. up to 1,000 m</p> <p>operating temperature: -15°C to + 70°C</p> <p>resistance: max. 75 Ω/km</p> <p>conductor capacity: max. 120 nF/km</p>



C-BRIDGE 2		Intermediary device for communication between the controller and DATA 2 series addressable devices. The control panel is equipped with one splitter as a standard, but optionally it is possible to connect a second signal splitter, thus increasing the maximum possible number of fittings to 512.	
C-BRIDGE 2 DATA 2 EASY DIN		C-BRIDGE 2 DATA 2 EASY	For mounting in dedicated housings.
For DIN rail mounting in switching stations and shafts.			
Supply voltage	22-25 V DC	Supply voltage	22-25 V DC
Number of fittings operated	< 64 / channel	Number of fittings operated	< 64 / channel
Number of channels	4	Number of channels	4
Interface	RS-485 (for PC LAN connection, DATA 2 C-Panel control unit), TM-BUS	Interface	RS-485 (for PC LAN connection, DATA 2 C-Panel control unit), TM-BUS
Bus voltage	15-25 V	Bus voltage	15-25 V
Bus communication speed	5 kbit/s	Bus communication speed	5 kbit/s
Communication speed	RS-485: 19200 bit/s	Communication speed	RS-485: 19200 bit/s
Insulation class	III	Insulation class	III
Mounting	T-35 rail		

There is also available a version built in the [C-BRIDGE BOX 2](#), allowing communication with emergency lighting fittings, while maintaining the parameters of C-BRIDGE DATA 2.



DATA 2

SELF-CONTAINED ADDRESSABLE SYSTEM



- » Monitoring of a configured system with up to 4096 fittings
- ideal for medium-sized and large investments.
- » All parameters of the fittings, the addresses of which are displayed in the control panel, are downloaded by the panel in a continuous manner.
- » The control unit has a built-in rechargeable battery that allows to monitor the fittings even during a loss of primary power supply.
- » Possibility to download reports and logs stored in the device's memory.
- » Software update via USB port.
- » Communication between the panel and fittings is carried out by means of the built-in C-BRIDGE 2 signal splitter, through the two-wire TM-Bus communication bus, which does not require polarisation maintenance.
- » Password protection for different levels of rights.
- » Cooperation with smart building systems.

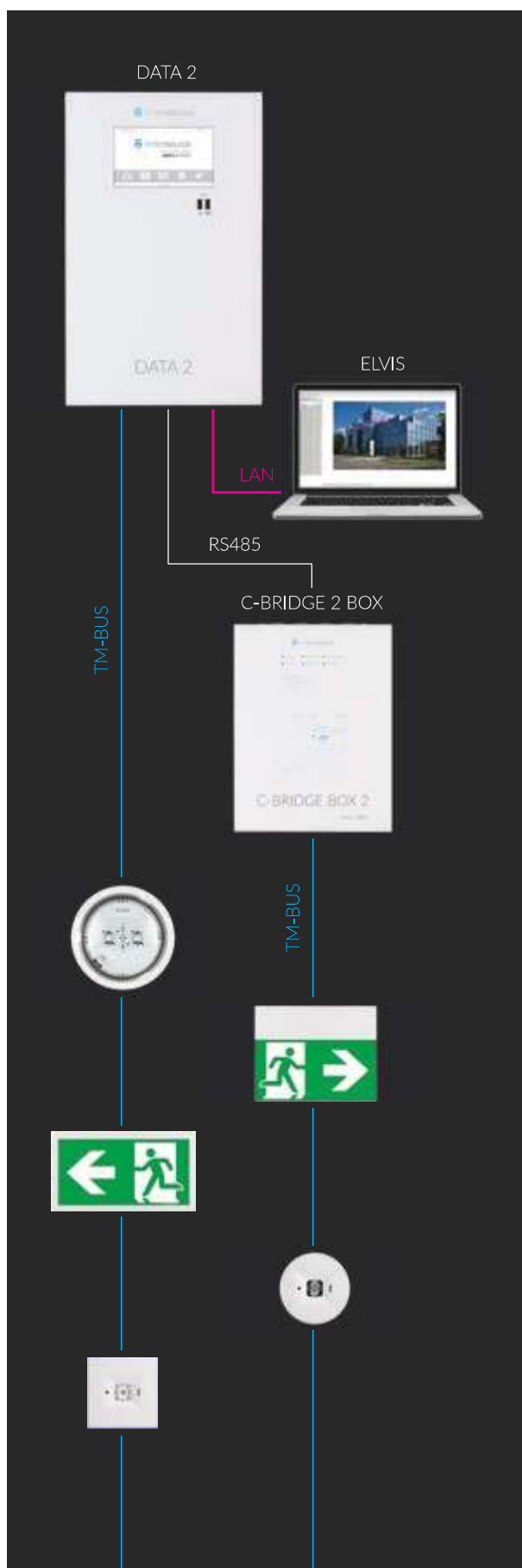

$$64 \times 4 \times 16 = 4096$$

maximum number of emergency
fittings / channel

maximum number
of communication channels

maximum number
of signal distributor

maximum number of emergency
fittings in the system

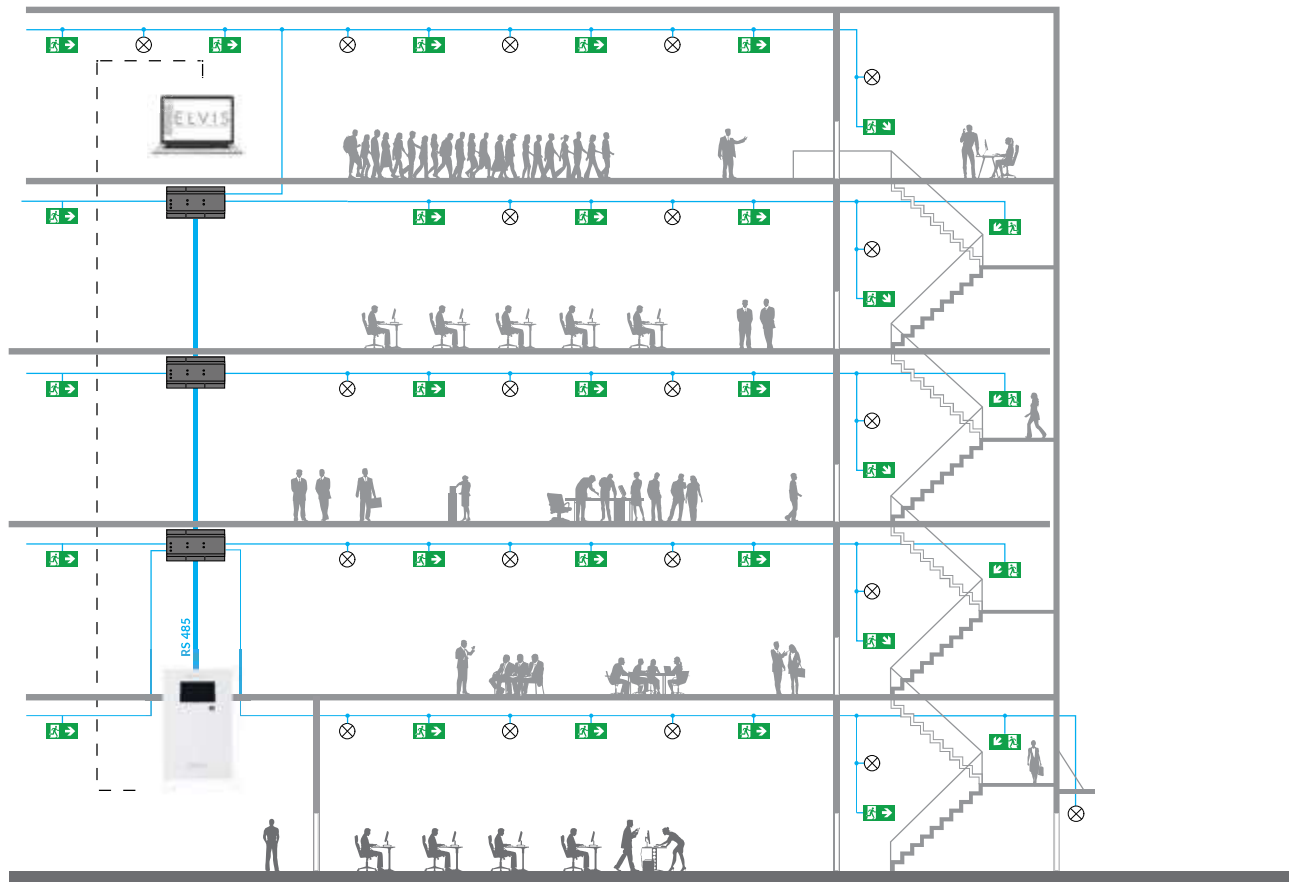

central station



ELVIS/BMS/SCADA

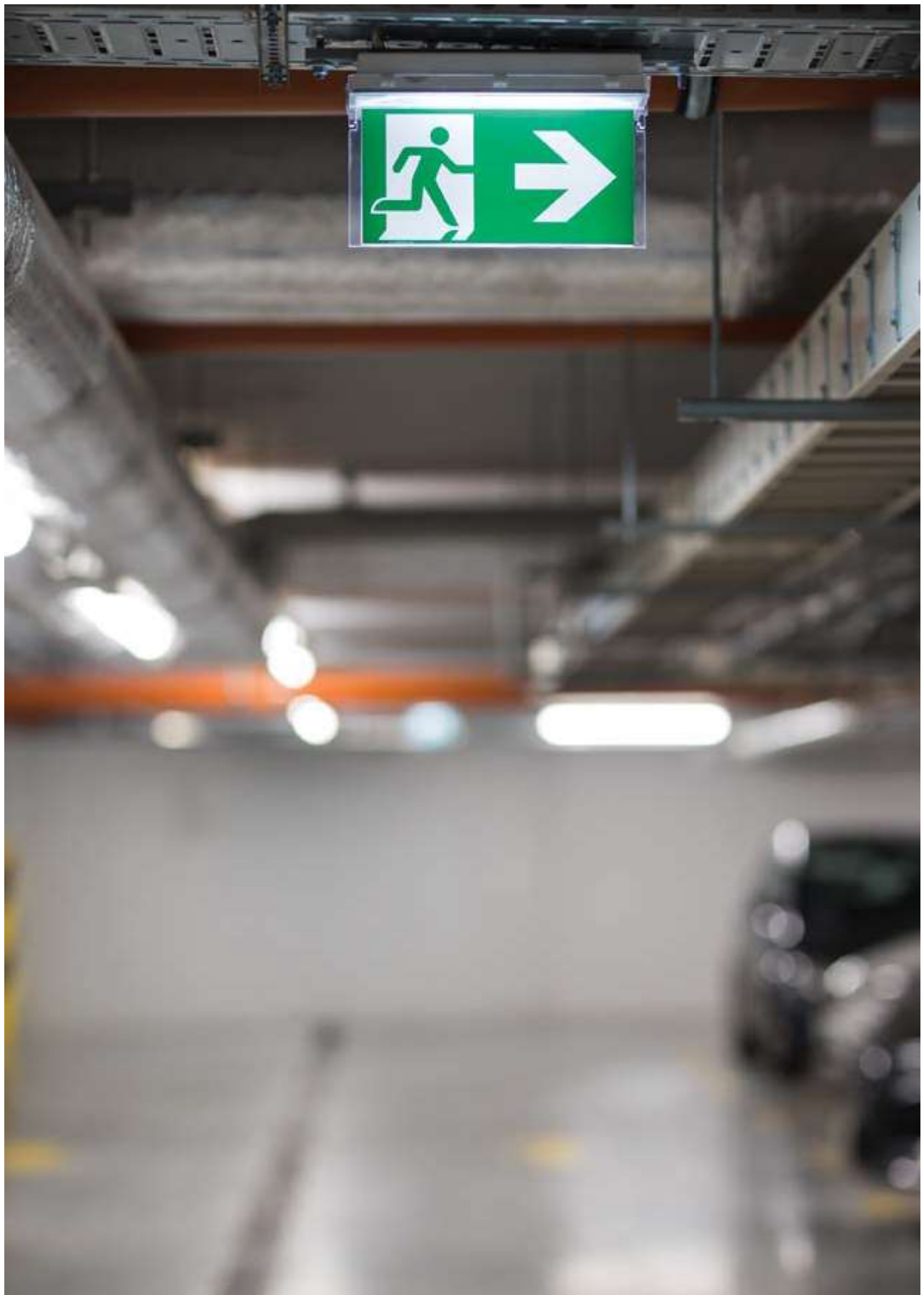

HOUSING DATA 2

Dimensions (H x W x D)	485 x 302 x 70 mm
Material	RAL 9003 powder coated black steel
Protection degree	IP20
Insulation class	I

BASIC SYSTEM PARAMETERS

Max. number of emergency fittings / channel	64
Maximum number of communication channels	4
Maximum number of C-Bridge 2 signal distributor	16
Max. number of emergency fittings in the system	4096

WIRING

Communication with controller	RS 485 port
Communication with ELVIS, WWW, MODBUS TCP	LAN
Communication with addressable devices	<p>TM-BUS 2-wire data bus (without polarity) - communication cable</p> <p>for example: YTKSYekw 1 x 2 x 0.8 mm² or other wires complying with the parameters:</p> <p>length: max. up to 1,000 m</p> <p>operating temperature: -15°C to + 70°C</p> <p>resistance: max. 75 Ω/km</p> <p>conductor capacity: max. 120 nF/km</p>

CONTROLLER

Multifunctional device with touch panel. Controls emergency luminaires. Possibility to download reports on the flash drive and preview the system status through the website.

Main menu	The following controls are available on the home page: system, luminaires, lighting groups, organiser, settings.
System	The "system" menu allows you to quickly determine the system status.
Fittings	The luminaires window allows you to view the status of luminaires installed in the system.
Test groups	The system allows you to add 128 test groups. The task of the groups is to automatically (regularly) trigger tests according to the preset schedule.
Organiser	After selecting the "Organiser" control it is possible to switch to the following modules: reports, logs, backups.
Settings	In the main menu, after selecting the settings control, it is possible to configure the panel settings: users, network, time panel, info.

I/O MODULE

Device enabling control of emergency lighting groups, dedicated to DATA 2 and TM-CB emergency lighting systems. IN input and OUT output models are available. The DATA 2 and TM-CB system allows the connection of up to 16 I/O modules. The address of each module is set on DiP-switches on their housing. IN SW, IN 24, IN 230 version is used to control the night lighting, fire-emergency lighting groups, fire scenarios and has 8 inputs. The output module (OUT) is used to inform about the system status. It has 8 potential-free outputs.

VERSIONS

IN SW	potential-free input
IN 24	24 V voltage detection
IN 230	230 V voltage detection
OUT	potential-free output 400 V AC/ 250 V DC, maks. 6 A
1 TM-I/O	2,4 W
2 DR-15-12, 12 V 15 W	1,2 W
3 CCA 2x0,75 mm	1,2 W

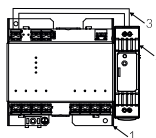

I/O MODULE MODELS PARAMETERS

Model	Power IN	P_{max}	I_{max}	$IN_{1-8} U_{max}$	$K_{1-8} U_{max}$	$K_{1-8} I_{max}$	I,II,III
OUT	12 V DC $\pm 10\%$	2,4 W	170 mA	-	400 V AC / 250 V DC	6 A	⊕
IN SW	12 V DC $\pm 10\%$	1,2 W	100 mA	-	-	-	⊕
IN 24	12 V DC $\pm 10\%$	1,2 W	100 mA	30 V DC	-	-	⊕
IN 230	12 V DC $\pm 10\%$	1,2 W	100 mA	250 V AC	-	-	⊕



C-BRIDGE 2		Intermediary device for communication between the controller and DATA 2 series addressable devices. The control panel is equipped with one splitter as a standard, but optionally it is possible to connect a second signal splitter, thus increasing the maximum possible number of luminaires to 512.	
		<div>↓</div> <div>↓</div>	
C-BRIDGE 2 DATA 2 DIN		C-BRIDGE 2 DATA 2	With battery for mounting in dedicated housings.
Supply voltage	22-25 V DC	Supply voltage	22-25 V DC
Battery	LiFePO4 Battery Pack 19.2 V 3Ah (18650) Balanced	Output voltage	12 V DC 0,67 A
Number of luminaires operated	< 64 / channel	Number of luminaires operated	< 64 / channel
Number of channels	4	Number of channels	4
Interface	RS-485 (for PC LAN connection, DATA 2 C-Panel control unit), TM-BUS	Interface	RS-485 (for PC LAN connection, DATA 2 C-Panel control unit), TM-BUS
Bus voltage	15-25 V	Bus voltage	15-25 V
Bus communication speed	5 kbit/s	Bus communication speed	5 kbit/s
Communication speed	RS-485: 19200 bit/s	Communication speed	RS-485: 19200 bit/s
Insulation class	III	Insulation class	III
Mounting	T-35 rail		

There is also available a version built in the [C-BRIDGE BOX 2](#), allowing communication with emergency lighting fittings, while maintaining the parameters of C-BRIDGE DATA 2.

