

Driver LC 25/30/35/40W 600/700/800/900mA fixC SC ADV
advanced series



With strain-relief

Product description

- _ Fixed output LED Driver
- _ Can be either used built-in or independent with clip-on strain-relief (see accessory)
- _ Constant current LED Driver
- _ Output current 600, 700, 800 or 900 mA
- _ Max. output power 26.5, 31, 36 or 40.5 W
- _ Nominal life-time up to 50,000 h
- _ For luminaires of protection class I and protection class II
- _ Temperature protection as per EN 61347-2-13 C5e
- _ Independent LED Driver with cable clamps
- _ 5-year guarantee

Properties

- _ Casing: polycarbonate, white
- _ Type of protection IP20

Functions

- _ Overtemperature protection
- _ Overload protection
- _ Short-circuit protection
- _ No-load protection
- _ Surge protection voltage 1 kV (L to N)
- _ Surge protection voltage 2 kV (L/N to earth)

Website

<http://www.tridonic.com/87500344>

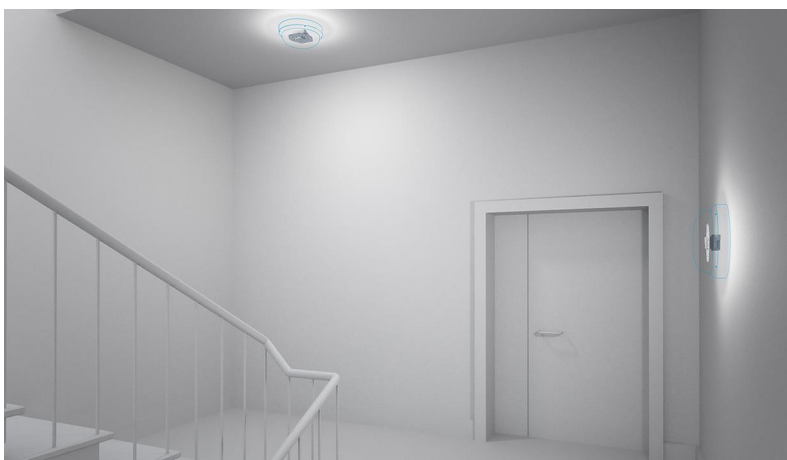

Spotlights



Downlights



Linear



Area



Floor | Wall



Free-standing



Street



Decorative



High bay

Driver LC 25/30/35/40W 600/700/800/900mA fixC SC ADV

advanced series

The complete data sheet for this product is available in the Downloads section.

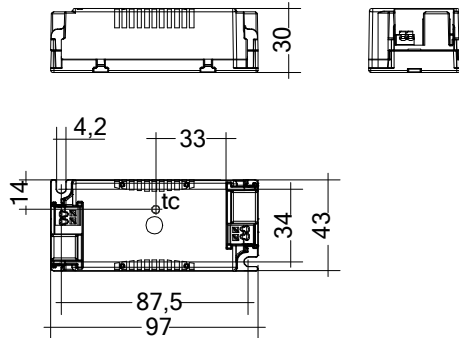

Ordering data

Type	Article number	Packaging, carton	Packaging, low volume	Packaging, high volume	Weight per pc.
LC 40W 900mA fixC SC ADV	87500344	15 pc(s).	555 pc(s).	4,440 pc(s).	0.102 kg

Technical data

Rated supply voltage	220 – 240 V
AC voltage range	198 – 264 V
Mains frequency	50 / 60 Hz
Overvoltage protection	320 V AC, 1 h
THD (at 230 V, 50 Hz, full load)	< 20 %
Output current tolerance ^①	± 7.5 %
Typ. current ripple (at 230 V, 50 Hz, full load)	± 5 %
Max. output voltage (U-OUT)	60 V
Starting time (at 230 V, 50 Hz, full load)	≤ 0.5 s
Turn off time (at 230 V, 50 Hz, full load)	≤ 0.2 s
Hold on time at power failure (output)	0 s
Ambient temperature <i>t</i> _a	-20 ... +50 °C
Ambient temperature <i>t</i> _a (at life-time 50,000 h)	40 °C
Storage temperature <i>t</i> _s	-40 ... +80 °C
Dimensions L x W x H	97 x 43 x 30 mm
Dimensions with strain-relief L x W x H	157 x 43 x 30 mm

Approval marks



Standards

EN 55015, EN 61000-3-2, EN 61000-3-3, EN 61347-1, EN 61347-2-13, EN 61547, EN 62384

Specific technical data

Type	Output current ^①	Input current (at 230 V, 50 Hz, full load)	Input power (at 230 V, 50 Hz, full load)	Output power range	λ at full load	Efficiency at full load ^②	λ at min. load	Efficiency at min. load ^③	Min. forward voltage	Max. forward voltage	Max. output peak current at full load	Max. output peak current at min. load ^④	Max. casing temperature e _{tc}
LC 40W 900mA fixC SC ADV	900 mA	0.210 A	45.3 W	22.5 – 40.5 W	0.95C	89 %	0.9C	83 %	25.0 V	45 V	1,161 mA	1,200 mA	83 °C

① Output current is mean value.

② Test result at 230 V, 50 Hz.

③ The trend between min. and full load is linear.